



## TULSA HISTORICAL SOCIETY & MUSEUM

The Travis Room features a western-facing glass wall, original library, sunroom and two fireplaces. Terrace has a fountain and is adjacent to an expansive tent pad with indoor access.



### FULL DAY RATE (best for 75 or more guests)

*Ten (10) hour rental period (12:00 pm – 10:00 pm)*

**Saturday - \$3,900 | Friday or Sunday - \$2,800 | Monday through Thursday - \$2,000**

### HALF-DAY RATE

*Six (6) hour rental period between 12:00 pm – 10:00 pm (restrictions apply during museum hours)*

**Saturday - \$2,400 | Friday or Sunday - \$1,800 | Monday through Thursday - \$1,200**

~ ADD Viewing Access to Museum Galleries and Exhibits - \$1,000 ~



### ADDITIONAL FEES

**Security Deposit** - Waived for “policy-friendly” events - \$600

**More Time** - Add up to two (2) extra hours to the day - \$275 per hour (**no events after 11:00 pm**)

**Extra Security** - Required when 150+ guests are present - \$200

**Cleaning Service** - Leave the final details after the event up to us! - \$350

**U.S. Holidays or Holiday Weekends** - \$350

**Outdoor Ceremony** - Every 50 chairs up to 150 - \$100

**Outdoor Reception** - Every 5 tables (8 chairs per table) up to 150 - \$150\*

### AMENITIES INCLUDED

\*Complimentary use of tent pad (tents, tables and chairs not provided)

“Choose Your Own” Catering Options + Preferred Vendor Referrals

Venue Chairs & Tables (150 chairs *total*) with One-Time Set-up

Two (2) Planning Meetings at the Venue + Unlimited Phone and Email Consultations

Access to Online Floorplan Tool with Vendor + Guest List Options

On-site Security + Venue Host | Free Unreserved Parking (100+ cars)

No Credit Card Fees + Easy Payment Plans | Support for a Non-Profit Cultural Institution

One (1) Hour Wedding Rehearsal (weekdays only, when available)

Rates and policies subject to change without notice – please ask about discounts or other special offers

# TRAVIS MANSION – FLOORPLAN

**MAXIMUM CAPACITY – 150**

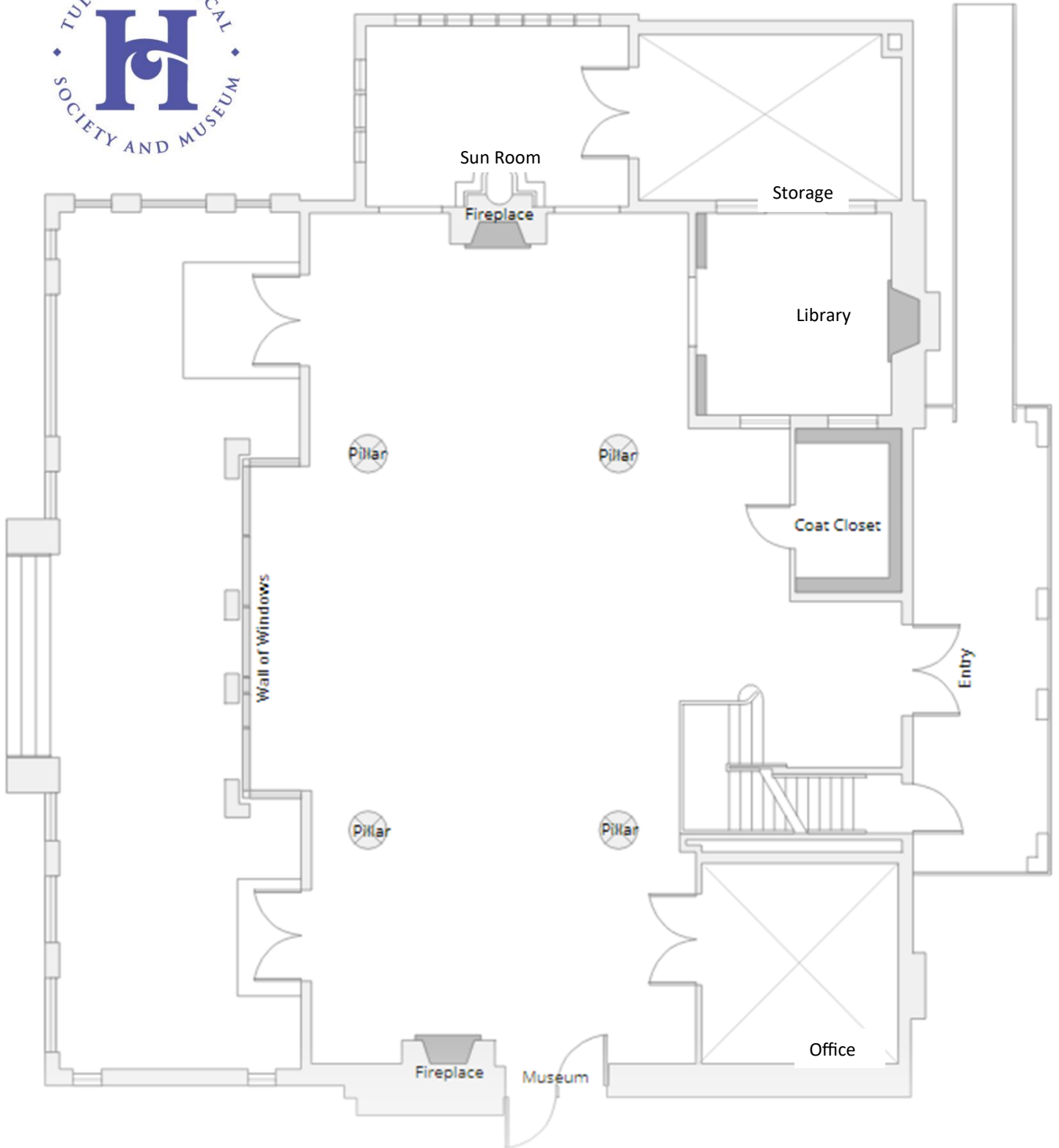

## Available Chairs

- 150 – folding, white
- 150 – metal, black (indoor use only)

## Available Tables

- 23 – 60” round
- 1 – 48” round
- 10 – 30” round adjustable height

- 16 – 8’ x 30 banquet
- 1 – 6’ x 18” banquet
- 1 – 6’ x 30” banquet
- 1 – 4’ x 30” banquet

Rates and policies subject to change without notice – please ask about discounts or other special offers